

**INFORMATION ONLY
NOT FOR ISSUE**

TE PUNA STATION ROAD

1800mmØ SW PIPE INSTALLATION
 DEPTH = 1.85 - -0.5 = 2.35m
 WIDTH = 3.5m GROSS TRENCH WIDTH
 LENGTH = 24.0m (TOTAL) / 10.1m OVER CURRENT ENTRANCE
 / 17.45m in Cut Area

PIPE - SOIL VOLUME REMOVED =
 - 10.1 (L) x 3.5m (w) x 2.35m (h) +
 - (17.45-10.1) x 3.5m (w) x 2.35/2 (Ave Ht) = 114 cubic metres

Embankment Filling
 - 5m x 2.35x (14.0+13.0) x 1/3 = 106 cubic metres

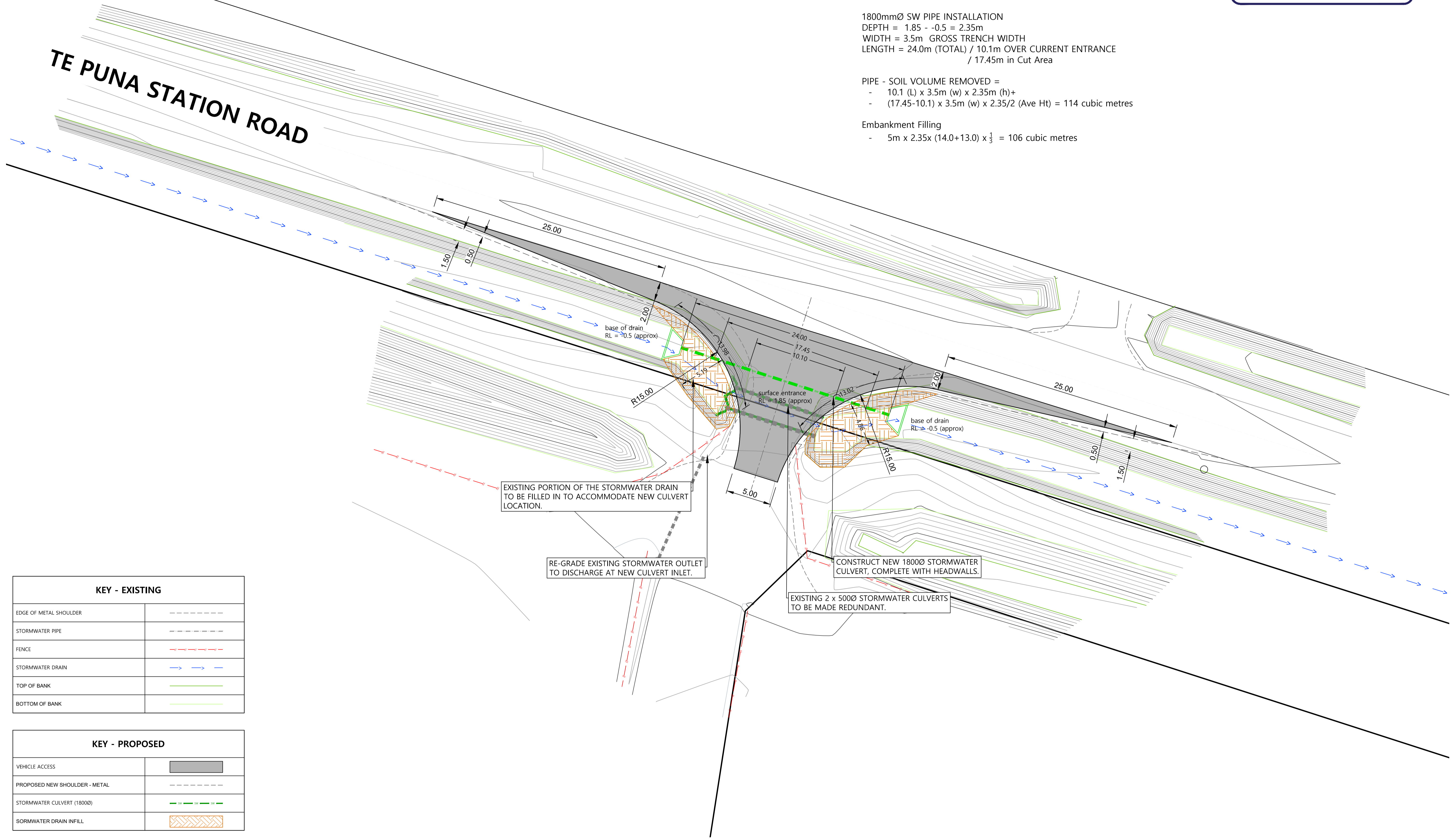

KEY - EXISTING	
EDGE OF METAL SHOULDER	---
STORMWATER PIPE	---
FENCE	- - - - -
STORMWATER DRAIN	→ → → → →
TOP OF BANK	---
BOTTOM OF BANK	---

KEY - PROPOSED	
VEHICLE ACCESS	█
PROPOSED NEW SHOULDER - METAL	---
STORMWATER CULVERT (1800Ø)	---
STORMWATER DRAIN INFILL	▨

No.	Date	Drawn	Approved	Issue/Revision
A	29.05.23	JB	TH	FOR INFORMATION ONLY
B	AUG 23	SB	SB	CULVERT / BATTER VOLUMES ADDED

TINEX GROUP Ltd
 245 TE PUNA STATION ROAD
 TE PUNA

INDUSTRIAL DEVELOPMENT
 LOT 2 DP22158
 PROPOSED ACCESS LAYOUT (SITE 1)

Drawing No. 423022-CIV-D001	
Sheet No. 02	Issue B
A1 SCALE: 1:200	

Stratum
 CONSULTANTS
 OFFICE: TAURANGA CONTACT: 07 571 4500