

Decision Report

Plan Change 22 – Definition of Self Contained

Important Note

The Proposed District Plan May 2011 Annotated Version was the current version of the District Plan when Plan Changes 1-27 were notified in November 2011 and this version was therefore used as the base document for preparing the Plan Changes and the Section 32 and Planning Reports.

Since then the District Plan has been made operative (16 June 2012). The Operative District Plan 2012 is now the current version of the District Plan and therefore Plan Changes 1-27 are proposed to change this version only.

For the purpose of understanding how decisions on this Plan Change relate to the Section 32 and Planning Report and to both versions of the District Plan discussed above, this Decision Report is divided into three parts.

Part A contains the decisions made on the topics in the Planning Report and uses the Proposed District Plan May 2011 Annotated Version as the base document.

Part B shows how the full notified Plan Change and subsequent decisions on topics would change the Proposed District Plan May 2011 Annotated Version Base Document.

Part C shows how the full notified Plan Change and subsequent decisions on topics are proposed to change the Operative District Plan 2012.

Advice to Submitters:

Submitters will be familiar with the rule and map numbers from the Proposed District Plan May 2011 Annotated Version and so should refer to Parts A and B of this report to understand the decisions on their submission points.

However any submitter wishing to make an appeal will need to refer to the rule and map numbers of the Operative District Plan 2012 in Part C and reference these in their appeal.

Part A: Decisions on Topics in the Planning Report

Any changes to rules are shown as follows; existing District Plan text in black, proposed changes as included in the Section 32 Report in [red](#), and any changes resulting from decisions on the topics in the Planning Reports in [blue](#).

Topic 1: Definition of Dwelling

Decision

That the definition of Dwelling be amended as follows:

“Dwelling” means [one](#) self contained residential unit designed for or occupied exclusively by one household and includes apartments, semi-detached and detached houses, home units, town houses and similar forms of residential development. [A dwelling may only contain one kitchen facility and one kitchenette.](#)”

The following submissions are therefore:

Accepted

Submission	Point Number	Name
13	5	Aurecon
47	13	Horticulture New Zealand and the New Zealand Kiwifruit Growers Incorporated

Accepted in Part

Submission	Point Number	Name
44	1	McDonald, Simon and Wiessing, Maniisha

Reason for Decision

The above definition is clear for District Plan users, it states how many self contained residential units are within a single dwelling and how many kitchens and kitchenettes a dwelling may contain. This will remove any confusion for people when they are looking at designing a dwelling as to what is permitted within a dwelling and what is not.

Topic 2: Definition of Self Contained

Decision

That there is no change to the definition of Self Contained as notified.

The following submission is therefore:

Rejected

Submission	Point Number	Name
44	2	McDonald, Simon and Wiessing, Maniisha

Reason for Decision

The above definition is clear for District Plan users; it reinforces the definition of dwelling.

Topic 3: Minor Edit to Definition of Kitchenette for Clarity

Decision

That the following minor edit be made to the definition of "kitchenette".

~~"Kitchenette" means a space which may contain a sink and does not meet the definition of 'kitchen facility' and is generally used for the purpose of tea and coffee making, a drinks bar and or the rinsing of utensils or tools etc but does not otherwise meet the definition of 'kitchen facility'.~~

Reason for Decision

The change was made for the purpose of clarity.

Part B: Changes to the Proposed District Plan May 2011 Annotated Version Base Document

Any changes to rules are shown as follows; existing District Plan text in black and changes (being the culmination of the notified Plan Change and subsequent decisions) are shown in red.

That the following amendment to the definition of Dwelling be included to read as follows;

“Dwelling” means one Self Contained residential unit designed for or occupied exclusively by one household and includes apartments, semi-detached and detached houses, home units, town houses and similar forms of residential development. A dwelling may only contain one Kitchen Facility and one Kitchenette.

That the following definition of Self Contained be included to read as follows;

“Self Contained” is where a building/dwelling contains a kitchen and/or kitchenette, a bathroom and a living area and/or bedroom and is separated from any other self contained area by being in another building, or where within the same building, by a door, a wall or a garage.

For example:

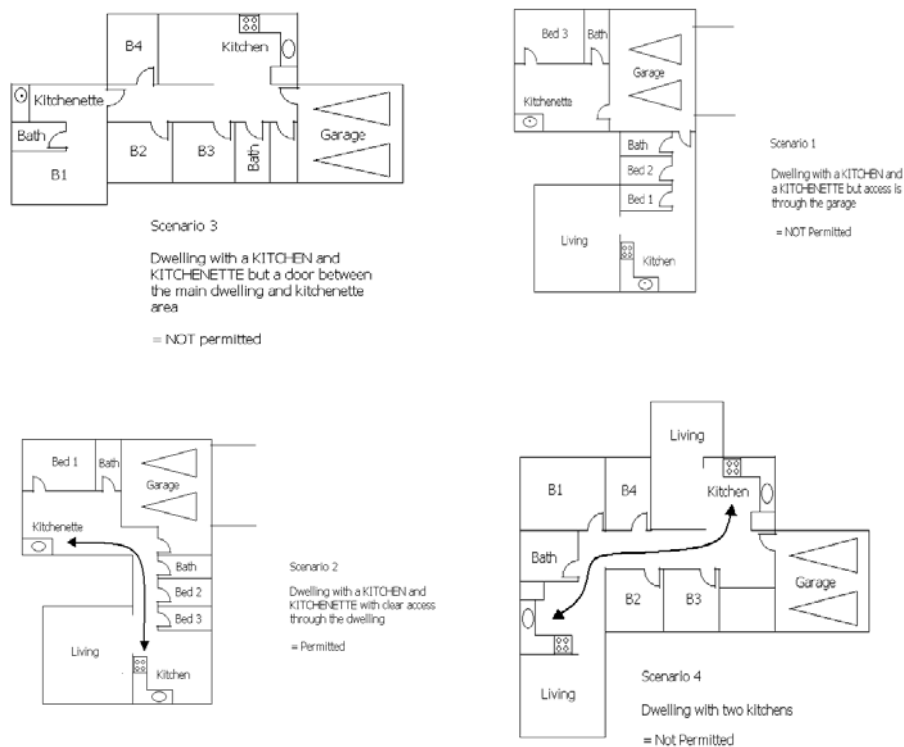

That the following definition of Kitchen Facility be included to read as follows:

“Kitchen Facility” means any space, facility or surface for the storage, preparation and/or cooking of food, the washing of utensils and the disposal of waste water, including a food preparation bench, sink, oven, stove, hotplate or separate hob, refrigerator, dish-washer and other kitchen appliance, this definition includes kitchenettes and tea and coffee making facilities”.

That the following definition of Kitchenette be included to read as follows:

“Kitchenette” means a space which may contain a sink and is generally used for the purpose of tea and coffee making, a drinks bar and or the rinsing of utensils or tools etc but does not otherwise meet the definition of ‘kitchen facility’.

Part C: Changes to the Operative District Plan 2012

Any changes to rules are shown as follows; existing District Plan text in black and changes (being the culmination of the notified Plan Change and subsequent decisions) are shown in red.

That the following amendment to the definition of Dwelling be included to read as follows;

“Dwelling” means one self contained residential unit designed for or occupied exclusively by one household and includes apartments, semi-detached and detached houses, home units, town houses and similar forms of residential development. A dwelling may only contain one Kitchen Facility and one Kitchenette.

That the following definition of Self Contained be included to read as follows;

“Self Contained” is where a building/dwelling contains a kitchen and/or kitchenette, a bathroom and a living area and/or bedroom and is separated from any other self contained area by being in another building, or where within the same building, by a door, a wall or a garage.

For example:

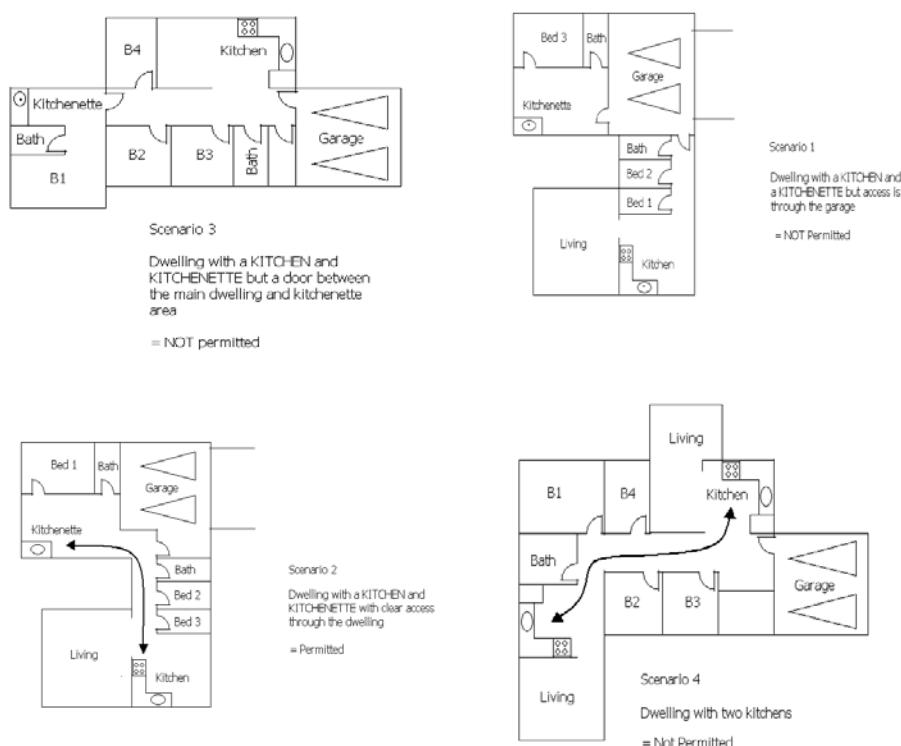

That the following definition of Kitchen Facility be included to read as follows:

“Kitchen Facility” means any space, facility or surface for the storage, preparation and/or cooking of food, the washing of utensils and the disposal of waste water, including a food preparation bench, sink, oven, stove, hotplate or separate hob, refrigerator, dish-washer and other kitchen appliance. This definition includes kitchenettes and tea and coffee making facilities”.

That the following definition of Kitchenette be included to read as follows:

"Kitchenette" means a space which may contain a sink and is generally used for the purpose of tea and coffee making, a drinks bar and or the rinsing of utensils or tools etc but does not otherwise meet the definition of *kitchen facility*.